

Part Number	Dim "A"	Dim "B"	Dim "C"
D-2868-HL	2'-7 3/4"	6'-7 1/8"	1'-7"
D-3068-HL	2'-11 3/4"	6'-7 1/8"	1'-11"
D-3668-HL	3'-5 3/4"	6'-7 1/8"	2'-5"
D-2870-HL	2'-7 3/4"	6'-11 1/8"	1'-7"
D-3070-HL	2'-11 3/4"	6'-11 1/8"	1'-11"
D-3670-HL	3'-5 3/4"	6'-11 1/8"	2'-5"

Left Hand Swing Shown

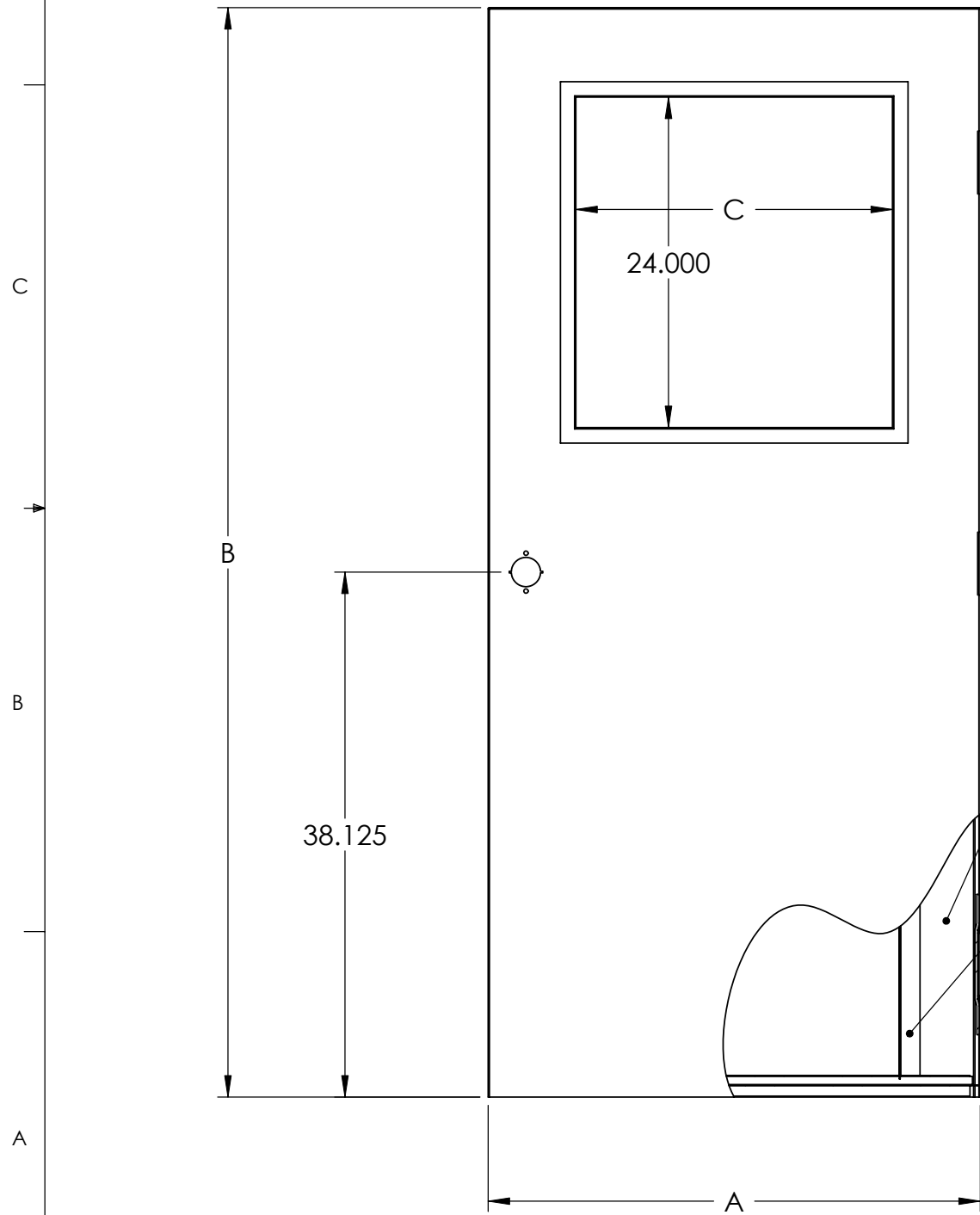

1/4" Clear Laminated Glass

Notched for 4 1/2" x 4 1/2" Heavy Hinge. Standard Hole Pattern.

US161L Prep

1 1/2" thick Sound Reducing Insulating Foam Board

16ga. 304 #4 Stainless Steel

14ga. Internal Support Steel Framing

PROPRIETARY AND CONFIDENTIAL
 THE INFORMATION CONTAINED IN THIS DRAWING IS THE SOLE PROPERTY OF SPECIALTY WELDING OF NY INC. ANY REPRODUCTION IN PART OR AS A WHOLE WITHOUT THE WRITTEN PERMISSION OF SPECIALTY WELDING OF NY INC. IS PROHIBITED.

UNLESS OTHERWISE SPECIFIED:		NAME	DATE	SYRACUSE, NEW YORK 13206 PH. 315-426-1807	
DIMENSIONS ARE IN INCHES TOLERANCES: +or -0.031 FRACTIONAL ± 1/32 ANGULAR: MACH ± BEND ± TWO PLACE DECIMAL ± THREE PLACE DECIMAL ±		Modeled By		SPECIALTY STAINLESS STEEL DOORS	
INTERPRET GEOMETRIC TOLERANCING PER:		Detailed By	dgraham	4/24/2009	TITLE:
MATERIAL		ENG APPR.			Half Lite Stainless Steel Door
FINISH		MFG APPR.			SIZE B
NEXT ASSY	USED ON	Q.A.			DWG. NO. D-3068-HL-LH spec
APPLICATION		COMMENTS:			REV
DO NOT SCALE DRAWING					SCALE: 1:12 WEIGHT: 236.542 SHEET 1 OF 1